

Electric Height Adjustable Desk

User Manual

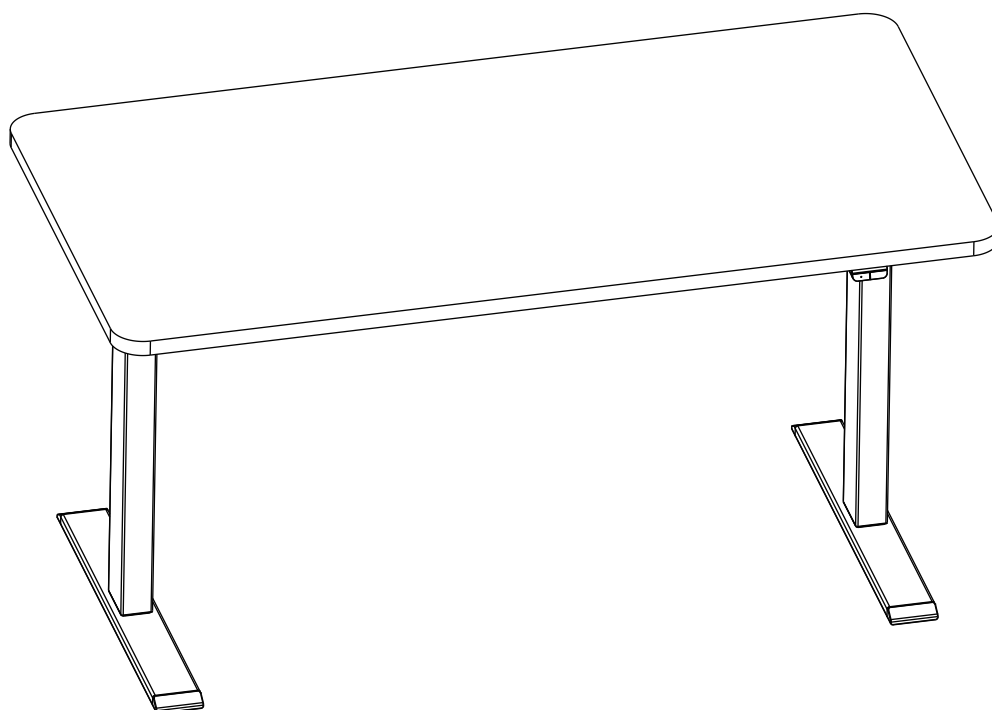

Warm prompt



Make sure no obstacles are in the desk's path.
Make sure the desktop is not touching any walls.
Make sure all cords are appropriate length to
accommodate the change in height.



WARNING

Pinch Point
Keep hands and
fingers clear.



Keep children away from electric height-adjustable desks, control
units and handsets. There is a risk of injury and electric shock.



Keep all electrical components away from liquids.



Do not sit or stand on the desk frame.
Do not crawl or lie under the desk frame.



Do not place any objects taller than 20" underneath the desk.



Do not open any of the components - the legs, Control Box, or Switch.
There is a danger of electric shock.



This product is designed with a duty cycle of 10%
(2 min. on, 18 min. off).



In the event of a power outage or if the power cord is unplugged,
a manual reset may be necessary - see USE section.



■ USE / LIABILITY

This height adjustable desk has electric motors and is designed for use in dry work areas only.

The desk height is adjustable so that it can be positioned at the most
ergonomically suitable height.

Any other use is at user's risk.

Under no circumstances does the manufacturer accept warranty claims or liability claims
for damages caused from improper use or handling of the desk frame.

IMPORTANT:

Please read this manual carefully.
If this desk is sold, please provide this manual to the buyer.

Package Contents

20min

Installation time



Installation
personnel

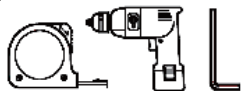

Installation tools
(self-provided)

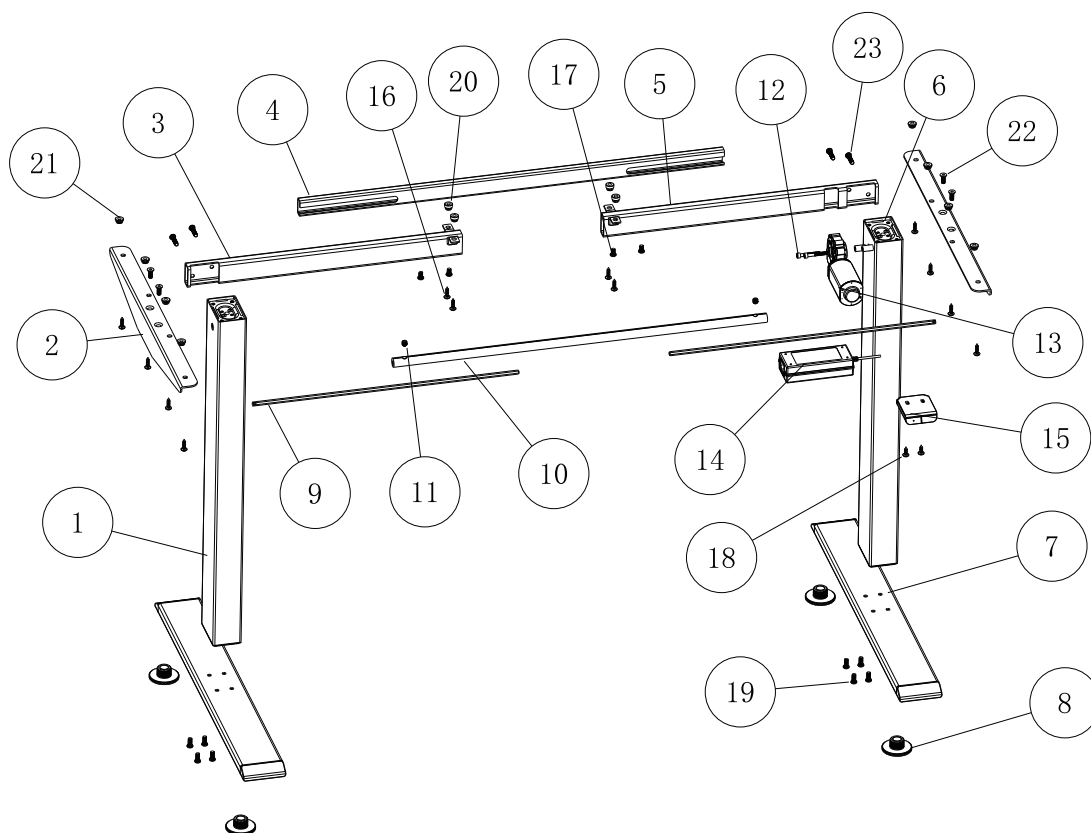

Part	Qty	Part	Qty	Part	Qty
1 Column(L)	1	9 Hexagon bar	2	17 M6*10 screw	4
2 Side bracket	2	10 drive rod	1	18 St5*16 screw	2
3 Frame(L)	1	11 M8*8 screw	2	19 M6*14 screw	8
4 Center rail	1	12 M5*35 screw	2	20 5mm rubber mat	4
5 Frame(R)	1	13 Motor	1	21 2mm rubber mat	8
6 Column(R)	1	14 Power Adapter	1	22 M6*16 screw	4
7 Foot	2	15 Hand control integrated	1	23 M6*25 screw	4
8 Foot glide	4	16 St5*20 screw	12		

ASSEMBLY

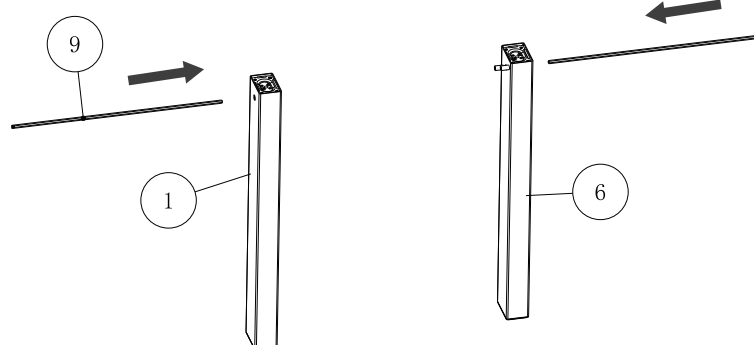

STEP 1: Insert two hexagonal rods(9) into the left(1) and right(6) columns respectively.

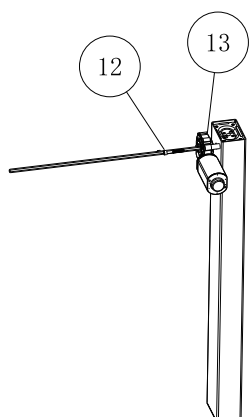

STEP 2: Install the motor(13) with two M5*35 screws(12).

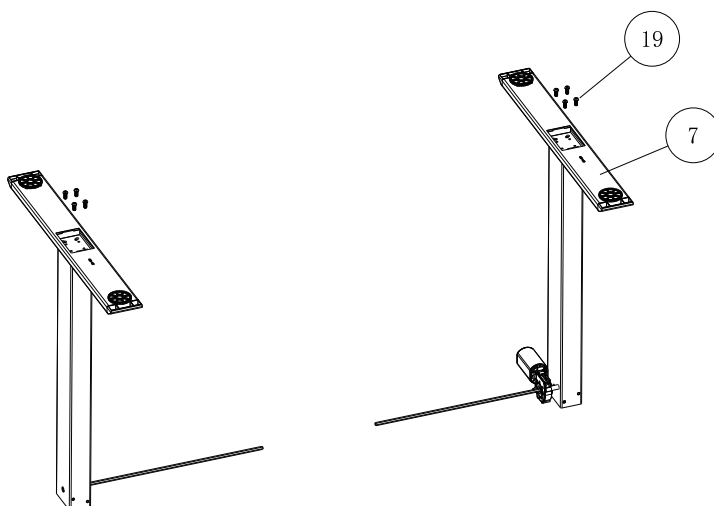

STEP 3: Install the feet(7) using 8 M6*14 screws(19)

ASSEMBLY

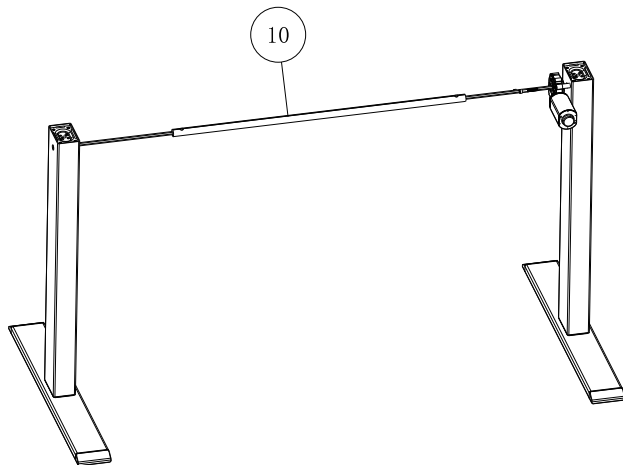

STEP 4: Install the aluminum drive rod(10).

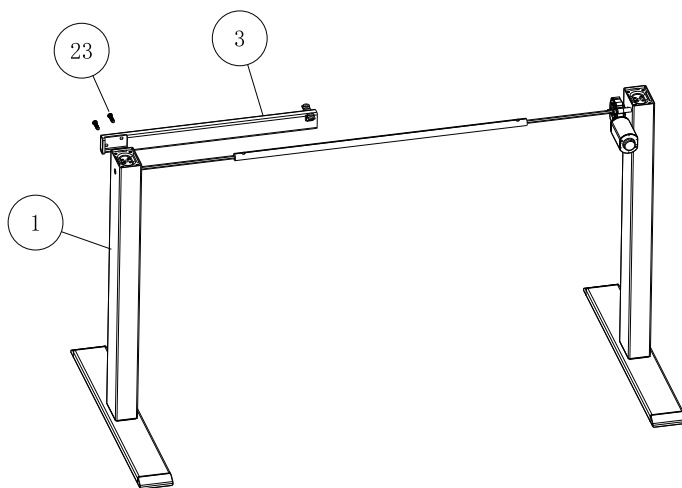

STEP 5: Install the frame(L)(3) on the Column(L)(1) using two M6*25 screws(23)

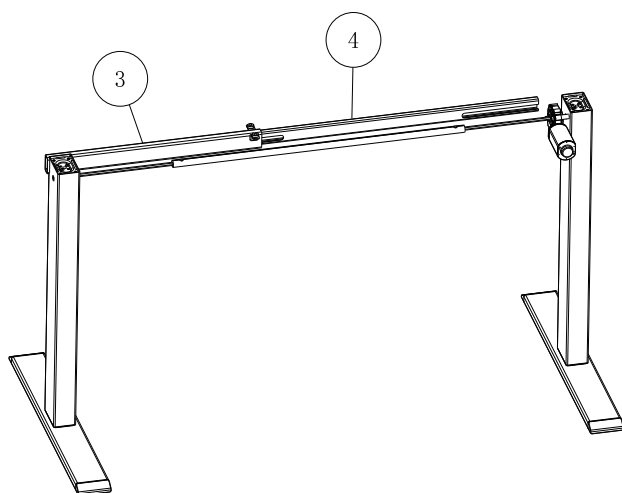

STEP 6: Insert the Center rail(4) into the frame(L)(3), noting the direction.

ASSEMBLY

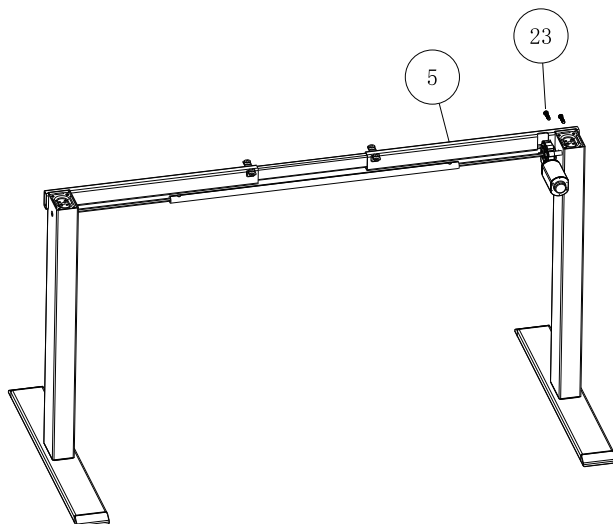

STEP 7: Install the frame(R)(5) using two M6*25 screws(23) .

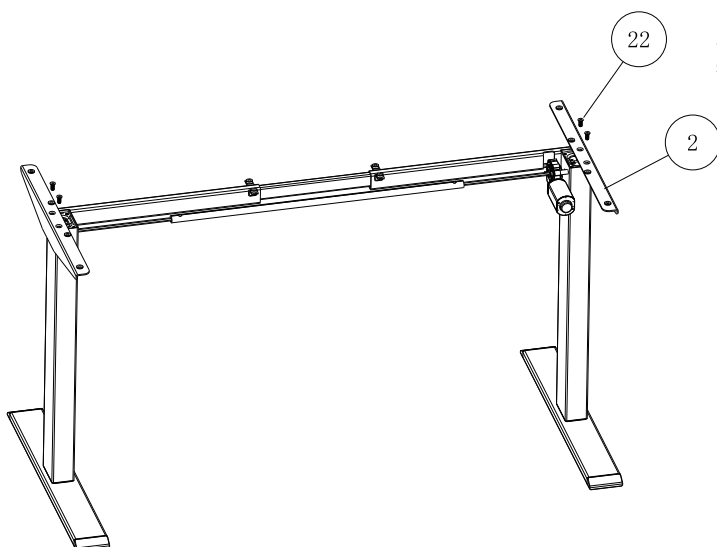

STEP 8: Install the side bracket(2) with 4 M6*16 countersunk screws(22).

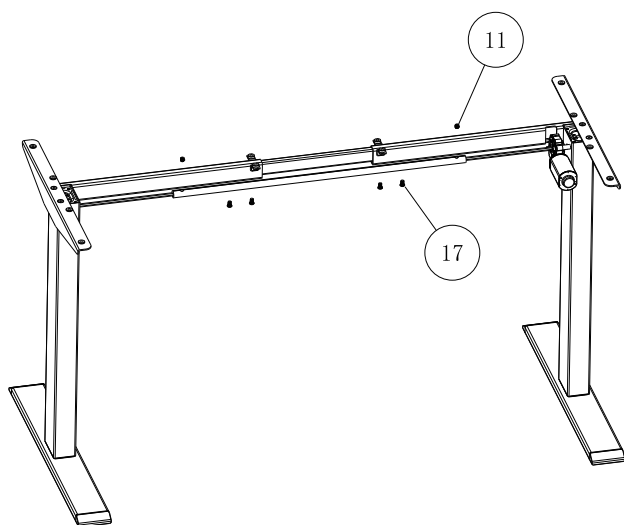

STEP 9: Adjust the whole table to the required length, then fix the frame and connecting rod with 4 M6*10(17) screws, and fix the aluminum transmission rod with 4 M8*8 screws(11).

Instructions

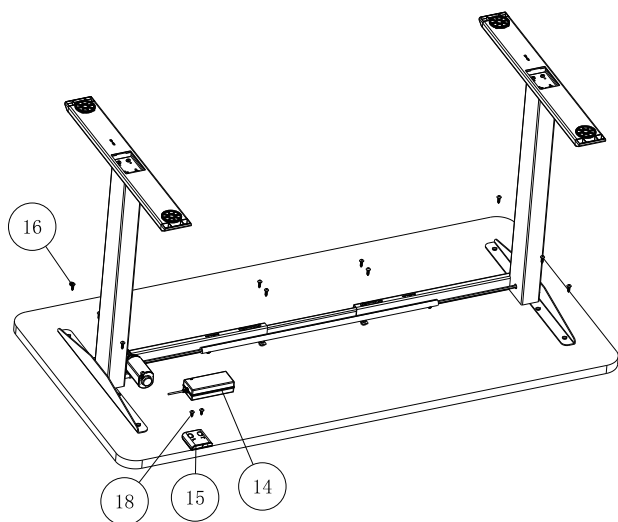

STEP 10:

The table plate is installed with 12 ST5*20 screws(16), and the hand control integrated(15) is installed with 2 ST5*16 screws(18).

The power adapter(14) is installed with felt pad.

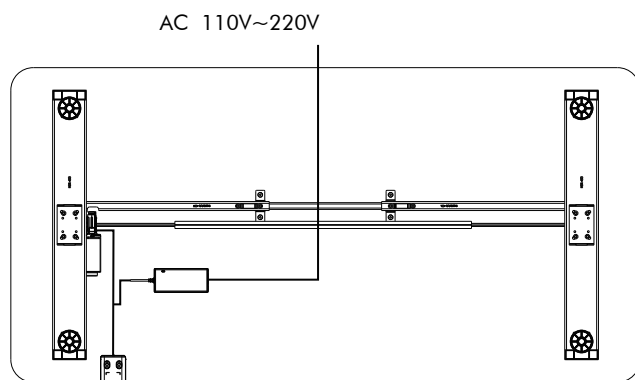

Maximum table size: 1600*800
Minimum table size: 1000*500

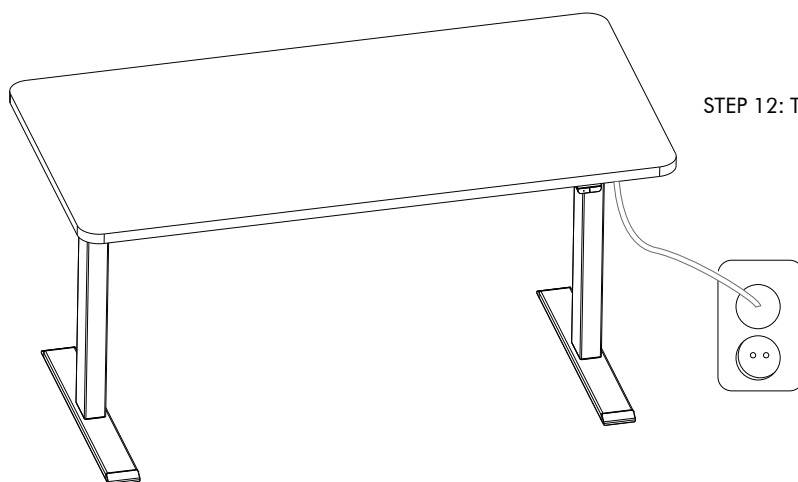

STEP 12: The installation is complete.



SPECIFICATIONS

Height Range	674-1174mm (without desktop)
Base Width	955mm min.- 1485mm max.
Speed	25mm/s
Load Capacity	500N
Duty Cycle	10% Max. 2 mins on, 18 mins off
	Soft start/ stop
	Adjustable leveling studs